



SERVICE MANUAL

AIR CONDITIONER

Please read this manual carefully before operating your set and retain it for future reference.

Ceiling Suspended Air Conditioner

EXPLODED VIEW

ARNU183V1A4, ARNU243V1A4, ARNU363V2A4, ARNU483V2A4



P/No.:MFL71786301

REV.00_102120

www.lghvac.com

www.lg.com

Copyright © 2020 LG Electronics Inc. All Rights Reserved.

1. Specification

Indoor

Model			Unit	ARNU183V1A4	ARNU243V1A4
Cooling capacity			kW	5.6	7.1
			kcal/h	4,800	6,100
			Btu/h	19,100	24,200
Heating capacity			kW	6.3	8.0
			kcal/h	5,400	6,900
			Btu/h	21,500	27,300
Dimensions	Body(WxDxH)		mm	1200 x 235 x 690	1200 x 235 x 690
			inch	47.2 x 27.0 x 9.3	47.2 x 27.0 x 9.3
Coil	RowsxColumnsxFPI			3x18x18	3x18x18
Fan	Type		CFF		CFF
	Motor Output × Number	W	145.7 x 1		145.7 x 1
	Air Flow Rate(H/M/L)	CMM	13.5 / 12.5 / 12		14 / 13 / 12
		cfm	477/441/424		494/459/424
	Drive		Direct		Direct
	Motor Type		BLDC		BLDC
Temperature Control			Microprocessor,Thermostat for cooling and heating		
Safety Device			Fuse		
Pipe Connection s	Liquid Side	mm(inch)	Ø6.35(1/4)		Ø9.52(3/8)
	Gas Side	mm(inch)	Ø12.7(1/2)		Ø15.88(5/8)
	Drain Pipe(Internal Dia.)	mm(inch)	16(0.6)		16(0.6)
Net Weight	Body	kg (lbs)	29(64)		29(64)
Noise Level		dB(A)	36 / 34 / 33		37 / 35 / 33
Power Supply		V,Φ,Hz	1, 208/230, 60		1, 208/230, 60
Refrigerant Control			EEV		EEV
Power cord			CV1.5 x 3C		CV1.5 x 3C
transmission Cable			V-SB 1.0~1.5 X 2C		V-SB 1.0~1.5 X 2C
panel Color			Morning fog		Morning fog

Note:

1. Capacities are based on the following conditions:

- Cooling:
- Indoor Temperature 27°C(80.6°F) DB/19°C(66.2°F) WB
 - Outdoor Temperature 35°C(95°F) DB/24°C(75.2°F) WB
- Heating:
- Indoor Temperature 20°C(68°F) DB/15°C(59°F) WB
 - Outdoor Temperature 7°C(44.6°F) DB/6°C(42.8°F) WB
- Piping Length
- Interconnecting Piping Length 7.5m
 - Level Difference of Zero

2. Wiring cable size must comply with the applicable local and national code.

3. The specification may be subject to change without prior notice for purpose of improvement.

Conversion Formula
kW = Btu/h x 0.0002931
cfm = CMM x 35.3

1. Specification

Indoor

Model			Unit	ARNU363V2A4	ARNU483V2A4
Cooling Capacity			kW	10.6	14.1
			kcal/h	9,100	12,100
			Btu/h	3,6200	48,000
Heating Capacity			kW	11.9	15.9
			kcal/h	10,200	13,200
			Btu/h	40,600	51,200
Dimensions (WxDxH)	Body (WxHxD)	mm	1600 x 690 x 235	1600 x 690 x 235	
		inch	63.0 x 27.0 x 9.3	63.0 x 27.0 x 9.3	
Coil	Rows x Columns x FPI		3 x 18 x 18	3 x 18 x 18	
Fan	Type		CFF	CFF	
	Motor Output x Number	W	145.7 x 1	145.7 x 1	
	Air Flow Rate(H / M / L)	CMM	27 / 24 / 20	29 / 24 / 20	
		cfm	953 / 848 / 706	1024 / 848 / 706	
	Drive		Direct	Direct	
	Motor type		BLDC	BLDC	
Temperature Control			Microprocessor, Thermostat for cooling and heating		
Safety Device			Fuse	Fuse	
Pipe Connections	Liquid Side	mm(inch)	Ø9.52(3/8)	Ø9.52(3/8)	
	Gas Side	mm(inch)	Ø15.88(5/8)	Ø15.88(5/8)	
	Drain Pipe(Internal Dia.)	mm(inch)	16(0.6)	16(0.6)	
Net Weight	Body	kg(lbs)	37(82)	37(82)	
Noise Level		dB(A)	45 / 44 / 40.5	47 / 44 / 40.5	
Power Supply		Ø, V, Hz	1, 208/230, 60	1, 208/230, 60	
Refrigerant Control			EEV	EEV	
Power cord			CV 1.5 x 3C	CV 1.5 x 3C	
Transmission cable			CVV-SB 1.0~1.5 X 2C	CVV-SB 1.0~1.5 X 2C	
Panel Color			Morning fog	Morning fog	

Note:

1. Capacities are based on the following conditions:

- Cooling:
- Indoor Temperature 27°C(80.6°F) DB/19°C(66.2°F) WB
 - Outdoor Temperature 35°C(95°F) DB/24°C(75.2°F) WB
- Heating:
- Indoor Temperature 20°C(68°F) DB/15°C(59°F) WB
 - Outdoor Temperature 7°C(44.6°F) DB/6°C(42.8°F) WB
- Piping Length
- Interconnecting Piping Length 7.5m
 - Level Difference of Zero

2. Wiring cable size must comply with the applicable local and national code.

3. The specification may be subject to change without prior notice for purpose of improvement.

Conversion Formula
kW = Btu/h x 0.0002931
cfm = CMM x 35.3

2. List of Functions

Category	Function	ARNU183V1A4 / ARNU243V1A4 / ARNU483V2A4 / ARNU483V2A4
Air flow	Air supply outlet	1
	Airflow direction control(left & right)	X
	Airflow direction control(up & down)	Auto
	Auto swing(left & right)	X
	Auto swing(up & down)	O
	Airflow steps(fan/cool/heat)	3 / 4 / 3
	Chaos wind(auto wind)	X
	Jet cool (Power wind)	O
	Swirl wind	X
Air purification	Triple filter	X
	Plasma air purifier	X
	Pre-Filter(washable / anti-fungus)	O
Installation	Drain pump	X
	E.S.P. control*	X
	Electric heater(operation)	X
	High ceiling operation*	O
Reliability	Hot start	O
	Self diagnosis	O
	Soft dry operation	O
Convenience	Auto changeover	O (Heat recovery / Heat pump)
	Auto cleaning	X
	Auto operation(artificial intelligence)	O (Cooling only)
	Auto restart operation	O
	Child lock*	O
	Forced operation	O
	Group control*	O
	Sleep mode	O
	Timer(on/off)	O
	Timer(weekly)*	O
	Two thermistor control*	O
Individual control	Wide wired remote controller (RS2 Plus)	PREMTB001/PREMTBB01
	Wide wired remote controller (RS3)	PREMTB100/PREMTBB10
	Premium wired remote controller	PREMTA000/PREMTA000A/PREMTA000B
	Simple wired remote controller	PQRCVCL0Q(W)
	Wired remote controller (for hotel use)	PQRCHCA0Q(W)
	Wireless LCD remote controller	PQWRH(C)Q0FDB
	Wi-Fi Controller	PWFMD200
Special function kit	Zone controller	-
	CTI (Communication transfer interface)	-
	Electronic thermostat	-
	Remote temperature sensor	-
	Group control wire	PZCWRCG3
	Dry contact	PDRYCB000/PDRYCB300/PDRYCB320/PDRYCB400/PDRYCB500
	Independent Power Module	PRIP0
	Refrigerant Leakage Detector	PRLDNVS0

Note

1. O : Applied, X : Not Applied

Accessory : Ordered and purchased separately the accessory package referring to the model name provided and install at field.

Accessory line-ups varies by region, so check your local catalogue or local sales material.

2. Some functions can be limited by remote controller.

3. In case of ducted type indoor units using the wireless remote controller, it needs to connect to the wired remote controller for received the signal of that.

4. * : These functions need to connect the wired remote controller.

3. Piping Diagrams

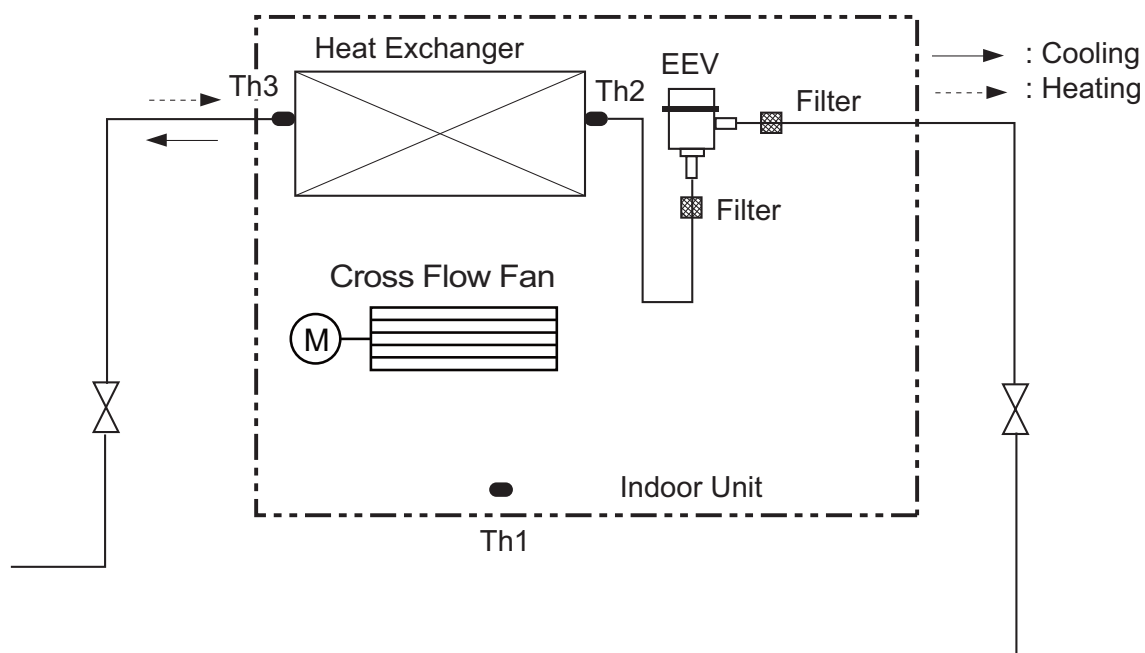

Unit:mm(inch)

Model	Gas	Liquid
ARNU183V1A4	Ø 12.7 (1/2)	Ø 6.35 (1/4)
ARNU243V1A4 ARNU363V2A4 ARNU483V2A4	Ø 15.88 (5/8)	Ø 9.52 (3/8)

LOC.	Description	PCB Connector
Th1	Thermistor for Inlet air temperature	CN_ROOM
Th2	Thermistor for Evaporator In temperature	CN_PIPE IN
Th3	Thermistor for Evaporator Out temperature	CN_PIPE OUT

4. Wiring Diagrams

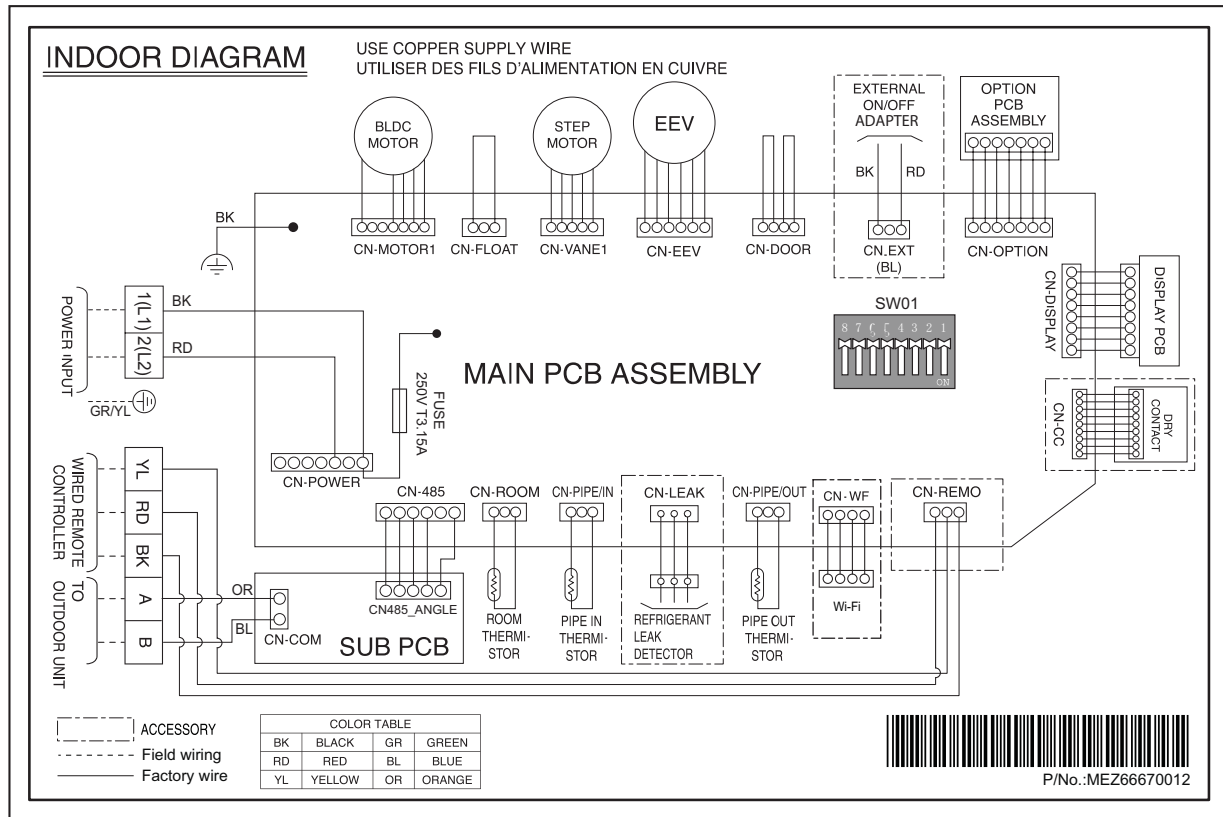

CONNECTOR NUMBER	LOCATION POINT	FUNCTION
CN-MOTOR1	FAN MOTOR OUTPUT	MOTOR OUTPUT OF BLDC
CN-DISPLAY	DISPLAY	DISPLAY OF INDOOR STATUS
CN-ROOM	ROOM SENSOR	ROOM THERMISTOR
CN -PIPE/IN	EVA.IN PIPE SENSOR	EVA.IN PIPE THERMISTOR
CN-PIPE/OUT	EVA.OUT PIPE SENSOR	EVA.OUT PIPE THERMISTOR
CN-REMO	REMOTE CONTROLLER	REMOTE CONTROL LINE
CN-CC	DRY CONTACT	DRY CONTACT LINE

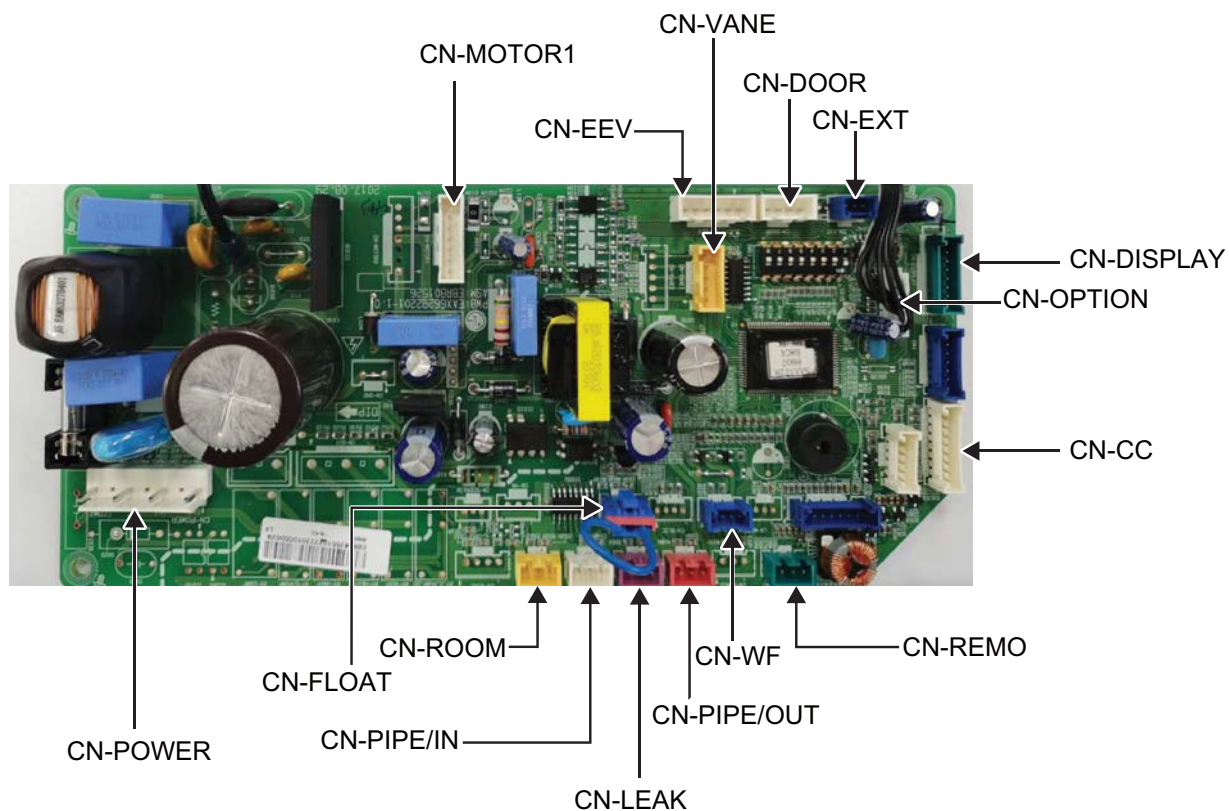

5. Exploded View

Indoor Unit

VM1

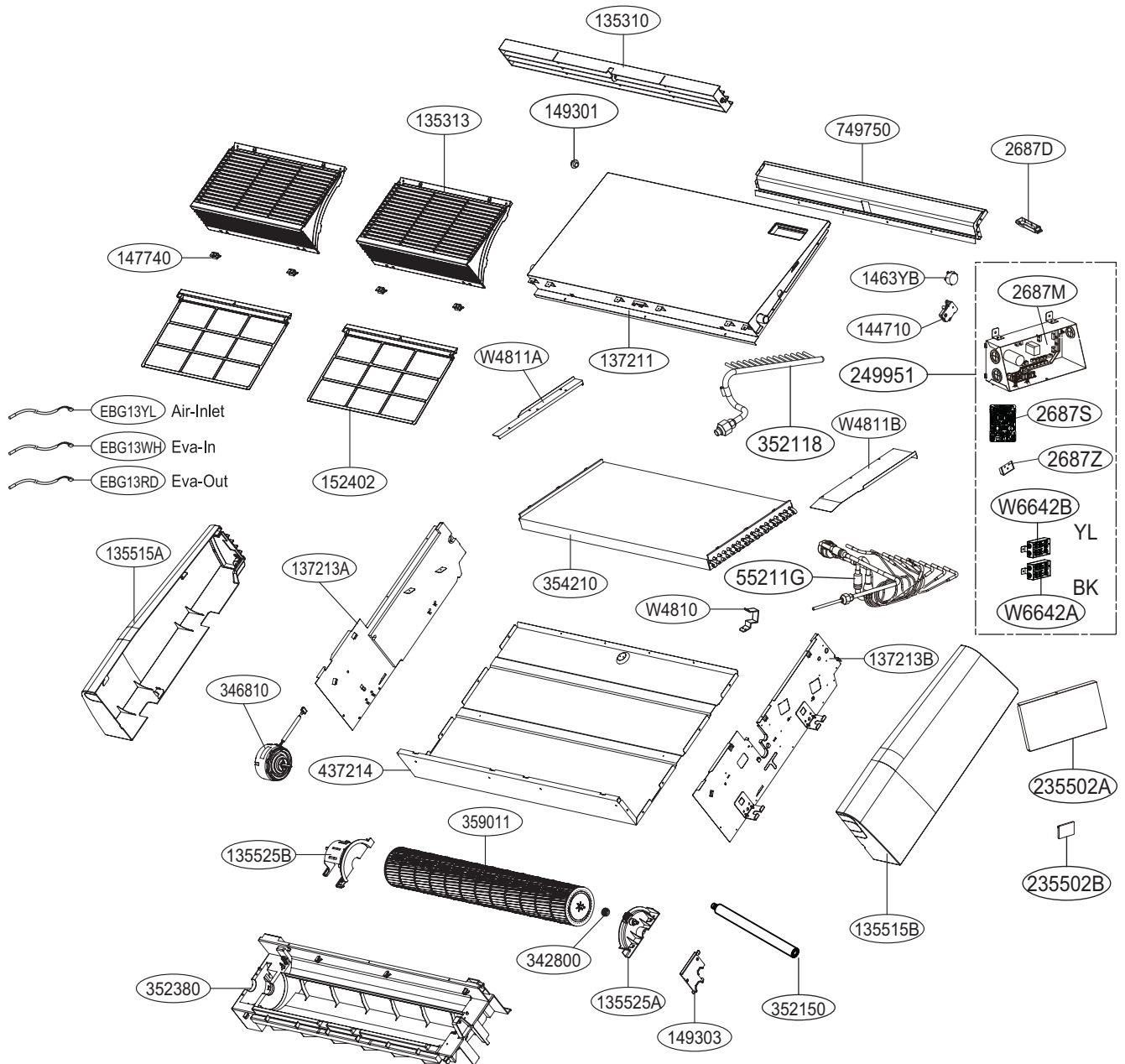

Location No.	Description	Sensor Information	Housing Color
EBG13YL	Thermistor1(CN_ROOM)	Indoor Room thermistor	Yellow
EBG13WH	Thermistor2(CN_PIPE/IN)	Indoor in-piping thermistor	White
EBG13RD	Thermistor3(CN_PIPE/OUT)	Indoor out-piping thermistor	Red

Note) * Please ensure GCSC since the replacement parts may be changed depending upon the buyer's request.
Please check the correct parts in View RPL(Replacement Part List) on GCGS.
(GCGS Website <http://biz.Lgservice.com>)

5. Exploded View

VM2

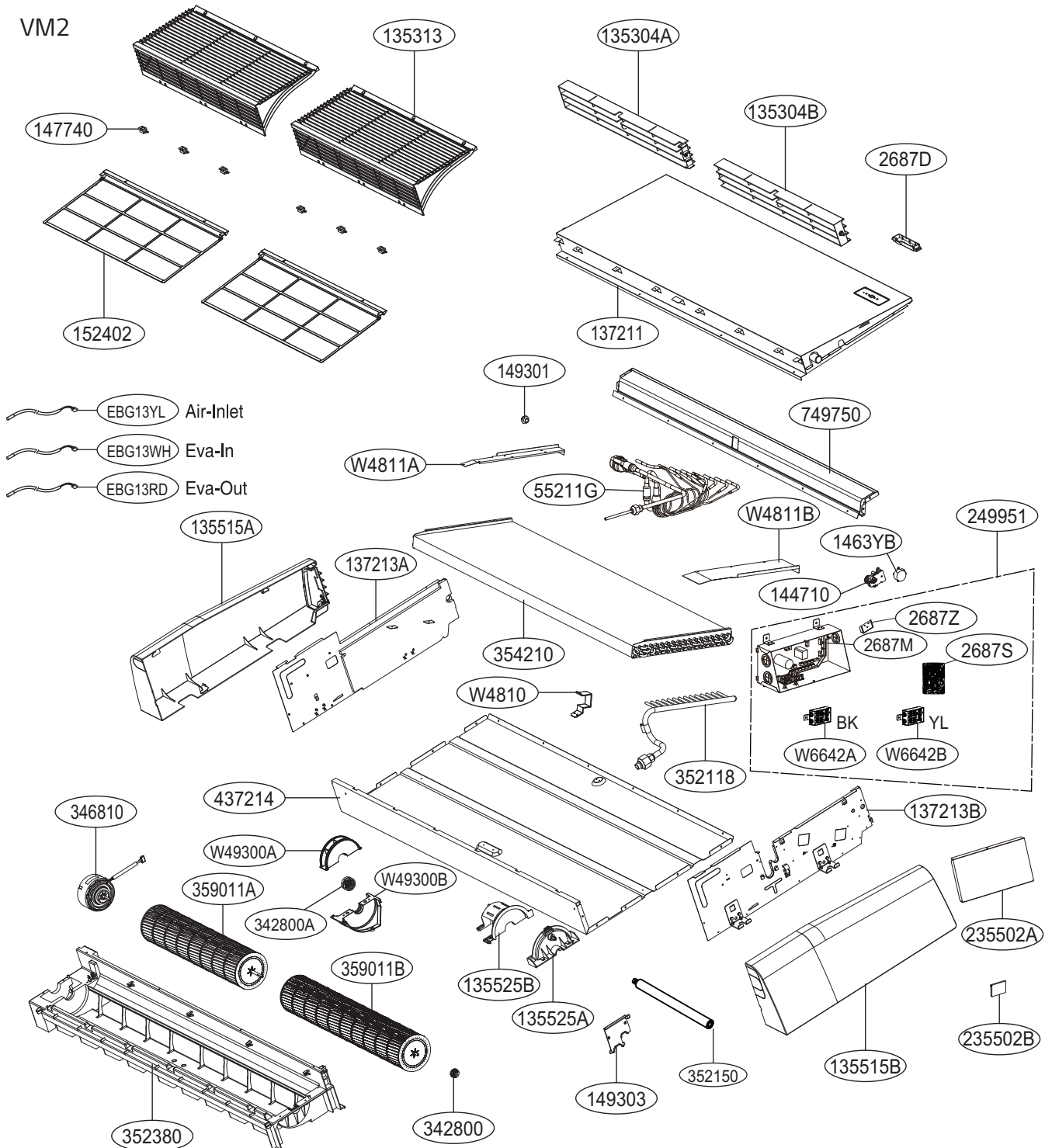

Thermistor 1	EBG13YL	Air	Housing color : Yellow
Thermistor 2	EBG13WH	Evaporator In	Housing color : White
Thermistor 3	EBG13RD	Evaporator Out	Housing color : Red

Note) * Please ensure GCSC since the replacement parts may be changed depending upon the buyer's request.
Please check the correct parts in View RPL(Replacement Part List) on GCGS.
(GCGS Website <http://biz.Lgservice.com>)



US	Please call the installing contractor of your product, as warranty service will be provided by them.
CANADA	Service call Number # : (888) LG Canada, (888) 542-2623 Numéro pour les appels de service : LG Canada, 1-888-542-2623