



Internal Use Only

<http://biz.lgservice.com>

Multi V Air Conditioner

SVC MANUAL(Exploded View)

**MODEL : ARNU093VEA2, ARNU123VEA2
ARNU183VJA2, ARNU243VJA2**

CAUTION

Before Servicing the unit, read the safety precautions in General SVC manual.
Only for authorized service personnel.

1. Specification

Type			Ceiling & Floor	
Model		Unit	ARNU093VEA2	ARNU123VEA2
Cooling Capacity		kW	2.8	3.6
		kcal/h	2,400	3,100
		Btu/h	9,600	12,300
Heating Capacity		kW	3.2	4.0
		kcal/h	2,800	3,400
		Btu/h	10,900	13,600
Casing			-	-
Dimensions(WxDxH)	Body	mm	900x200x490	900x200x490
		inch	35.4x7.9x19.3	35.4x7.9x19.3
Coil	Rows x Columns x FPI		2x12x20	2x12x20
	Face Area	m ² (ft ²)	0.10(1.1)	0.10(1.1)
Fan	Type		Cross Flow Fan	Cross Flow Fan
	Motor Output x Number	W	20	20
	Running Current	A	0.13	0.13
	Air Flow Rate(H/M/L)	CMM	7.6/6.9/6.2	9.2/7.6/6.9
		cfm	268/243/219	325/268/244
	Drive		Direct	Direct
	Motor type		BLDC	BLDC
Temperature Control			Microprocessor, Thermostat for cooling and heating	Microprocessor, Thermostat for cooling and heating
Sound Absorbing Thermal Insulation Material			Foamed polystyrene	Foamed polystyrene
Safety Device			Fuse	Fuse
Pipe Connections	Liquid Side	mm(inch)	Ø6.35(1/4)	Ø6.35(1/4)
	Gas Side	mm(inch)	Ø12.7(1/2)	Ø12.7(1/2)
	Drain Pipe(Internal Dia.)	mm(inch)	16(0.6)	16(0.6)
Net Weight		kg(lbs)	13.7(30.2)	13.7(30.2)
Noise Level(Sound Press, 1.5m, H/M/L)		dB(A)	36/32/28	38/36/30
Power Supply		Ø, V, Hz	1,208/230,60	1,208/230,60
Refrigerant Control			EEV	EEV
Power cable		mm ²	CV1.5 x 3C	CV1.5 x 3C
Transmission cable		mm ²	CVV-SB 1.25 x 2C	CVV-SB 1.25 x 2C
Color			Morning fog	Morning fog

Notes:-

1. Capacities are based on the following conditions:

- Cooling
 - Indoor temp. 27°C[80.6°F]DB/ 19°C[66.2°F]WB
 - Outdoor temp. 35°C[95°F]DB/ 24°C[75.2°F]WB
 - Interconnecting Piping Length 7.5m(24.6ft)
 - Level Difference of Zero
- Heating
 - Indoor temp. 20°C[68°F]DB/ 15°C[59°F]WB
 - Outdoor temp. 7°C[44.6°F]DB/ 6°C[42.8°F]WB
 - Interconnecting Piping Length 7.5m(24.6ft)
 - Level Difference of Zero

2. Capacities are net capacities

3. Due to our policy of innovation some specifications may be changed without prior notification

4. To be added for more available Models

5. EEV : Electronic Expansion Valve

Conversion Formula

kcal/h= kW x 860
 Btu/h = kW x 3412
 cfm = m³/min x 35.3
 l/s = CMM x 1000/60

Type			Ceiling Suspended	
Model		Unit	ARNU183VJA2	ARNU243VJA2
Cooling Capacity		kW	5.6	7.1
		kcal/h	4,800	6,100
		Btu/h	19,100	24,200
Heating Capacity		kW	6.3	8.0
		kcal/h	5,400	6,900
		Btu/h	21,500	27,300
Casing			Galvanized Steel Plate+Painting	Galvanized Steel Plate+Painting
Dimensions(WxDxH)	Body	mm	950x220x650	950x220x650
		inch	37.4x8.7x25.6	37.4x8.7x25.6
Coil	Rows x Columns x FPI		3x14x19	3x14x19
	Face Area	m²(ft²)	0.23(2.5)	0.23(2.5)
Fan	Type		Sirocco Fan	Sirocco Fan
	Motor Output x Number	W	154	154
	Running Current	A	0.40	0.40
	Air Flow Rate(H/M/L)	CMM	16/ 14 /12	18/16/14
		cfm	565/495/424	636/566/495
	Drive		Direct	Direct
	Motor type		BLDC	BLDC
Temperature Control			Microprocessor, Thermostat for cooling and heating	Microprocessor, Thermostat for cooling and heating
Sound Absorbing Thermal Insulation Material			Foamed polystrene	Foamed polystrene
Safety Device			Fuse	Fuse
Pipe Connections	Liquid Side	mm(inch)	Ø6.35(1/4)	Ø9.52(3/8)
	Gas Side	mm(inch)	Ø12.7(1/2)	Ø15.88(5/8)
	Drain Pipe(Internal Dia.)	mm(inch)	16(0.6)	16(0.6)
Net Weight		kg(lbs)	24.6(54.2)	24.6(54.2)
Noise Level(Sound Press, 1.5m, H/M/L)		dB(A)	42/40/37	43/41/39
Power Supply		Ø, V, Hz	1,208/230,60	1,208/230,60
Refrigerant Control			EEV	EEV
Power cable		mm²	CV1.5 x 3C	CV1.5 x 3C
Transmission cable		mm²	CVV-SB 1.25 x 2C	CVV-SB 1.25 x 2C
Color			Morning fog	Morning fog

Notes:-

1. Capacities are based on the following conditions:

- Cooling
 - Indoor temp. 27°C[80.6°F]DB/ 19°C[66.2°F]WB
 - Outdoor temp. 35°C[95°F]DB/ 24°C[75.2°F]WB
 - Interconnecting Piping Length 7.5m(24.6ft)
 - Level Difference of Zero
- Heating
 - Indoor temp. 20°C[68°F]DB/ 15°C[59°F]WB
 - Outdoor temp. 7°C[44.6°F]DB/ 6°C[42.8°F]WB
 - Interconnecting Piping Length 7.5m(24.6ft)
 - Level Difference of Zero

2. Capacities are net capacities

3. Due to our policy of innovation some specifications may be changed without prior notification

4. To be added for more available Models

5. EEV : Electronic Expansion Valve

Conversion Formula

kcal/h= kW x 860
 Btu/h = kW x 3412
 cfm = m³/min x 35.3
 l/s = CMM x 1000/60

2. List of Functions

Category	Function	ARNU093VEA2, ARNU123VEA2 ARNU183VJA2, ARNU243VJA2
Air flow	Air supply outlet	1
	Airflow direction control(left & right)	manual
	Airflow direction control(up & down)	auto
	Auto swing(left & right)	X
	Auto swing(up & down)	O
	Airflow steps(fan/cool/heat)	3/4/3
	Chaos swing	X
	Chaos wind(auto wind)	O
	Jet cool(Power wind)	O
	Swirl wind	-
Air purifying	Deodorizing filter	X
	Plasma air purifier	X
	Prefilter(washable / anti-fungus)	O
Installation	Drain pump	X
	E.S.P. control	X
	Electric heater(operation)	X
	High ceiling operation	O
Reliability	Hot start	O
	Self diagnosis	O
	Soft dry operation	O
Convenience	Auto changeover	O(only heat recovery)
	Auto cleaning	X
	Auto operation(artificial intelligence)	O(only heat pump or cooling only)
	Auto restart operation	O
	Child lock	O
	Forced operation	O
	Group control	O
	Sleep mode	O
	Timer(on/off)	O
	Timer(weekly)	O
	Two thermistor control	O
Individual control	Standard wired remote controller	Accessory
	Wide Character wired remote controller	Accessory
	Picto wired remote controller	
	Deluxe wired remote controller	Accessory
	Simple wired remote controller	Accessory
	Wired remote controller(for hotel use)	Accessory
	Wireless remote controller(simple)	X
	Wireless LCD remote control	Accessory
Special function kit	Zone control	-
	CTIE	-
	Electro thermostat	-

O : Applied X : Not applied - : No relation

Option : Model name & price are different according to options, and assembled in factory with main unit.

Accessory : Installed at field, ordered and purchased separately by the corresponding model name, supplied with separate package.

3. Piping Diagrams

VE

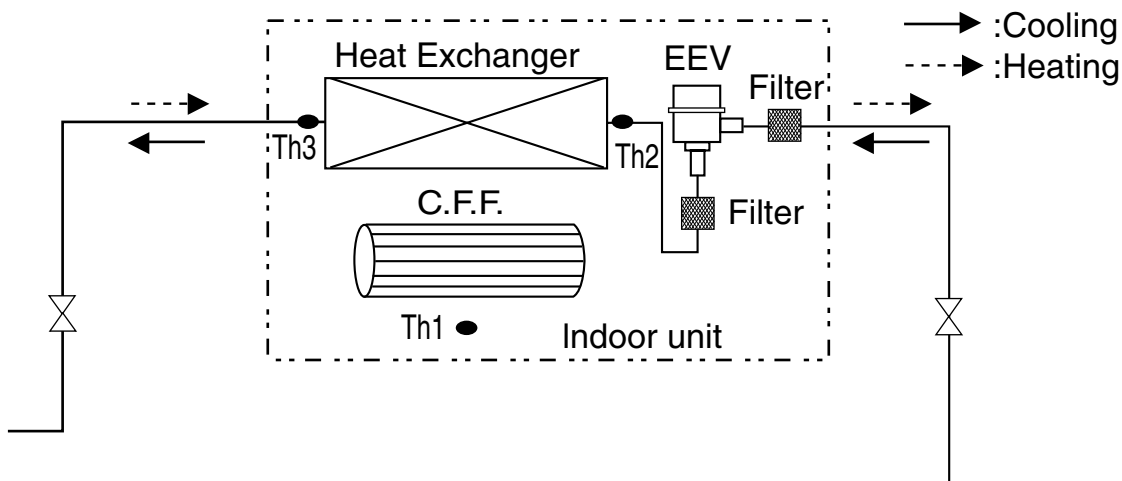

VJ

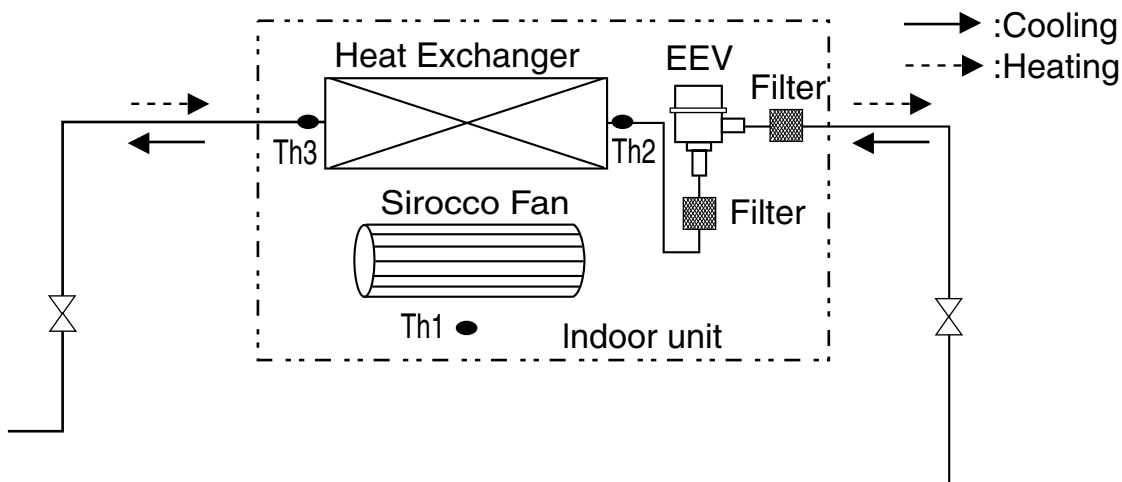

Refrigerant pipe connection port diameter

[unit: mm(inch)]

Model	Gas	Liquid
ARNU093VEA2	Ø12.7(1/2)	Ø6.35(1/4)
ARNU123VEA2	Ø12.7(1/2)	Ø6.35(1/4)
ARNU183VJA2	Ø12.7(1/2)	Ø6.35(1/4)
ARNU243VJA2	Ø15.88(5/8)	Ø9.52(3/8)

LOC.	Description
Th1	Room thermistor
Th2	Pipe in thermistor
Th3	Pipe out thermistor

4. Wiring Diagrams

VE Chassis

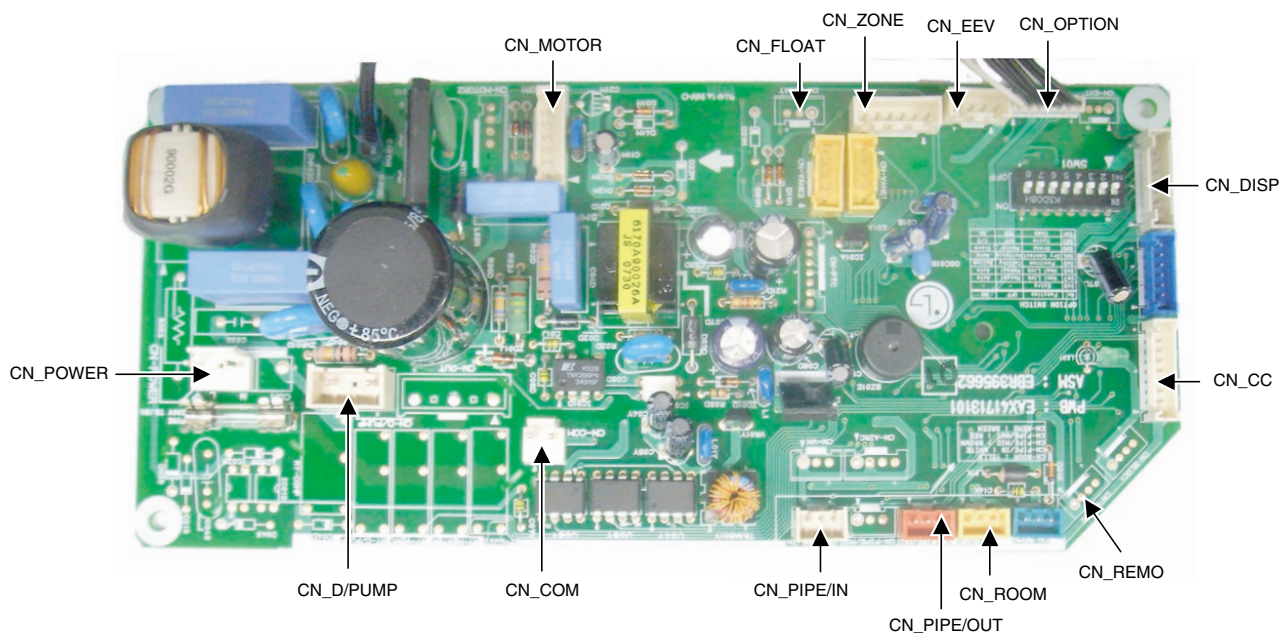
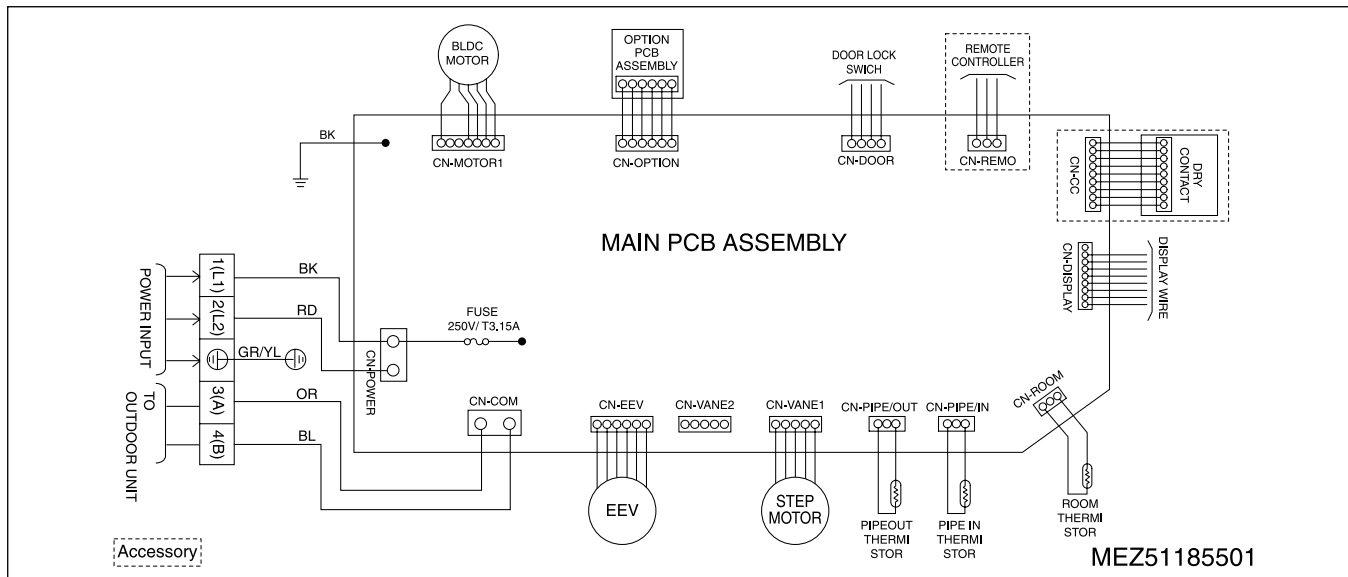

Dip Switch Setting		ON	OFF	Remarks
SW3	GROUP	Master	Slave	Group Control setting using Wired Remote Controller
SW4	DRY CONTACT	Variable	Auto	Dry contact mode setting
SW5	EXTRA 1	OFF	ON	1. Duct model -. OFF : Default(not operate continuously) -. ON : Fan operate continuously 2. Cassette Model : No Function 3. Ceiling Suspended Model -. OFF : Ceiling(default) -. ON : Floor

⚠ CAUTION

For Multi V Model, Dip Switch 1,2,5,6,7,8 must be set OFF
That dip switch is used for the other model.

VJ Chassis

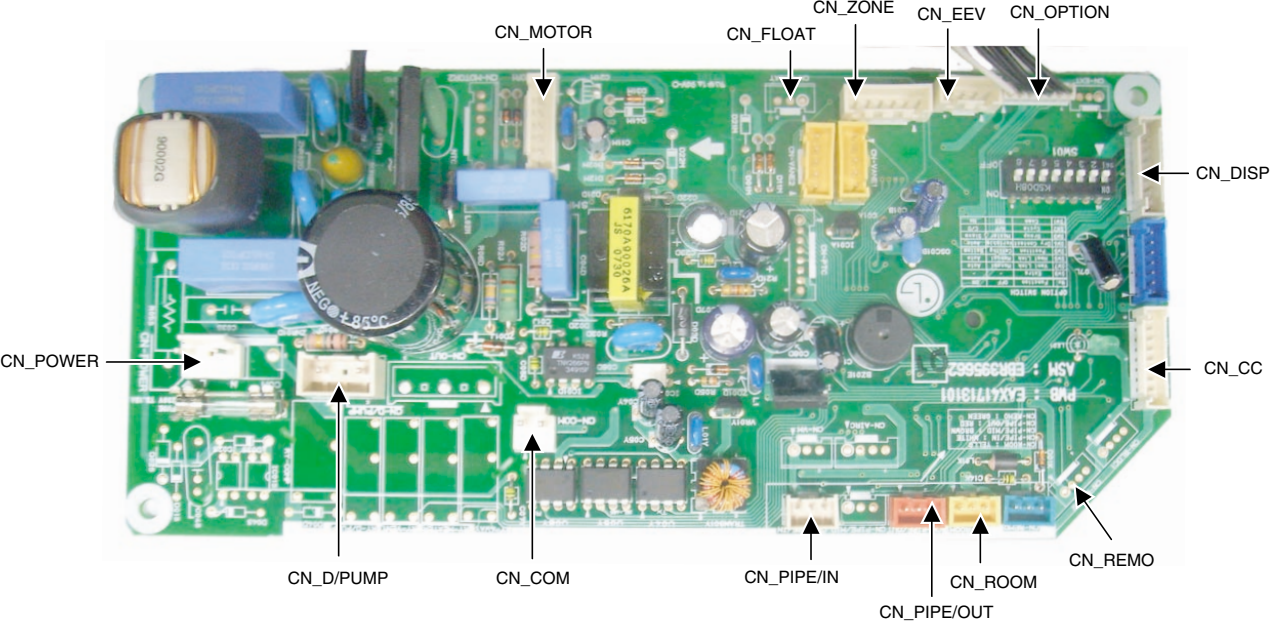
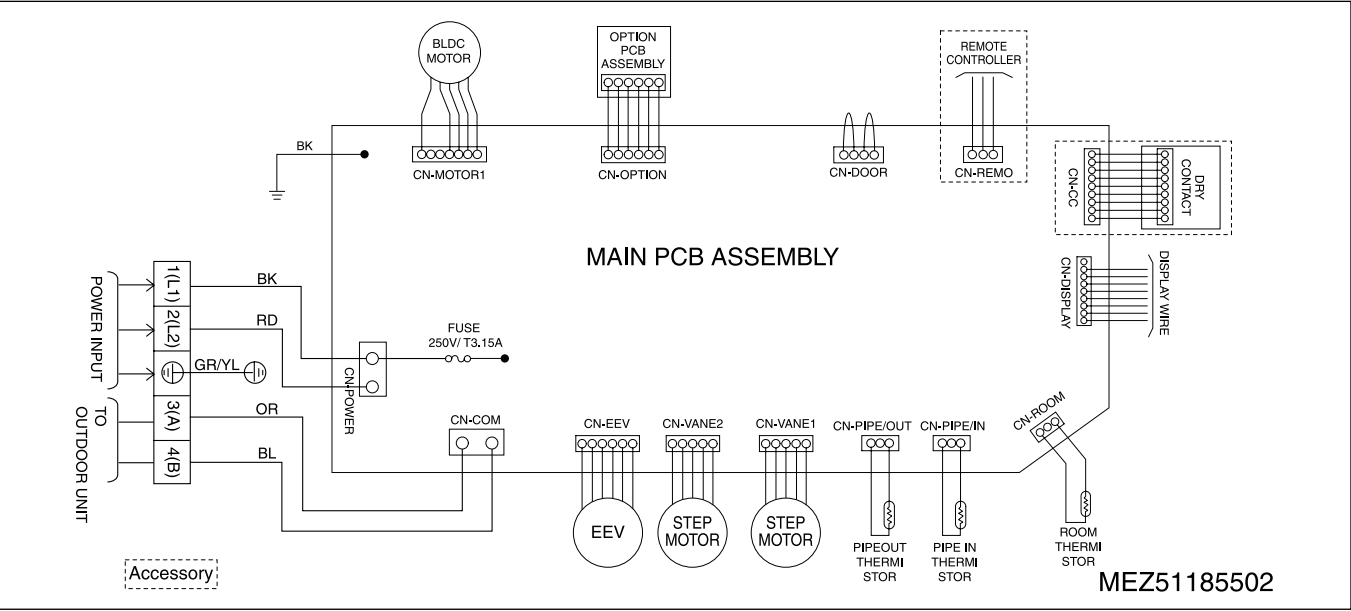

Dip Switch Setting		ON	OFF	Remarks
SW3	GROUP	Master	Slave	Group Control setting using Wired Remote Controller
SW4	DRY CONTACT	Variable	Auto	Dry contact mode setting
SW5	EXTRA 1	OFF	ON	1. Duct model -. OFF : Default(not operate continuously) -. ON : Fan operate continuously 2. Cassette Model : No Function 3. Ceiling Suspended Model -. OFF : Ceiling(default) -. ON : Floor

 **CAUTION**

For Multi V Model, Dip Switch 1,2,5,6,7,8 must be set OFF
That dip switch is used for the other model.

5. Exploded View

VE

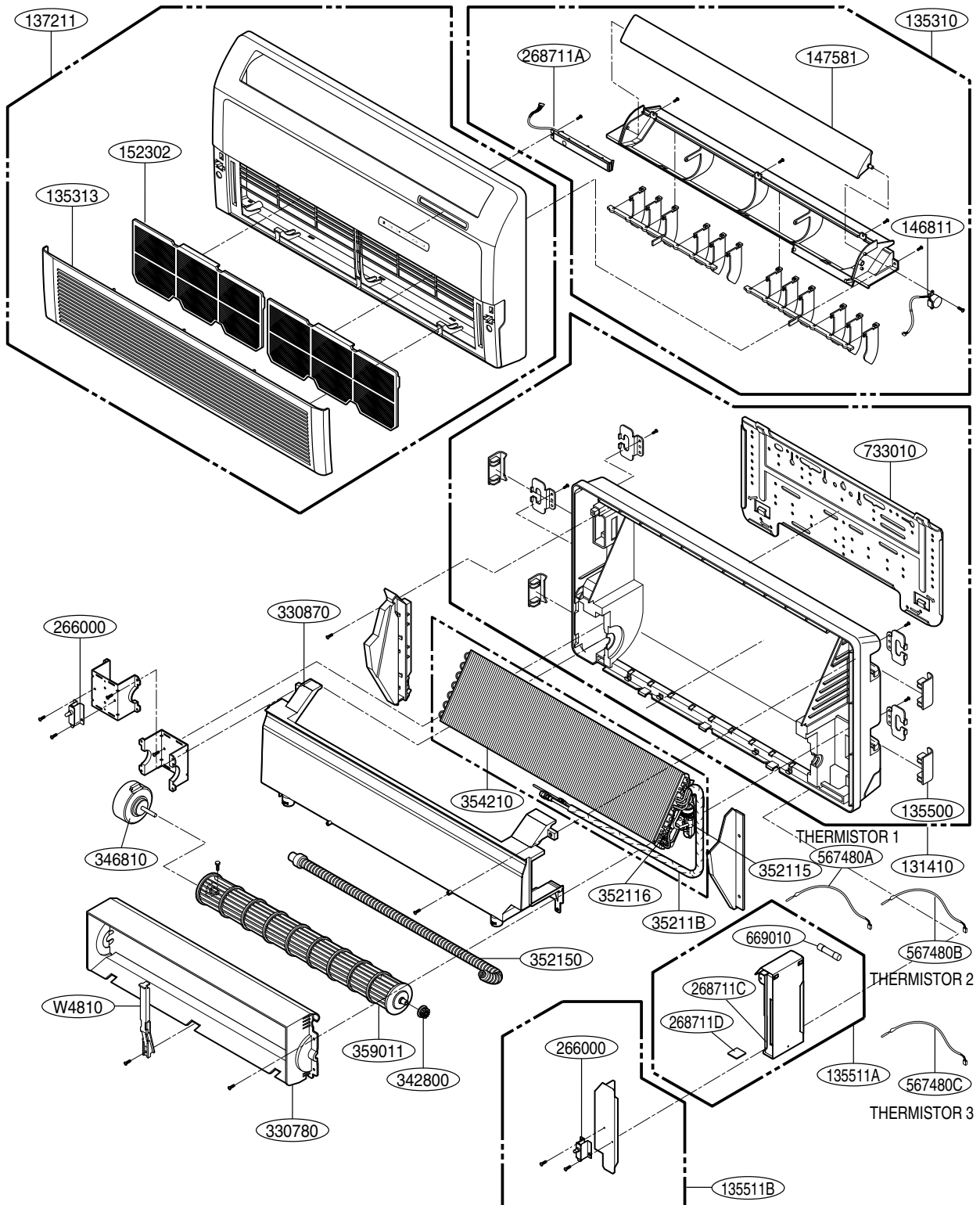

Thermistor 1	567480A	Air	Housing color : yellow
Thermistor 2	567480B	Eva. in	Housing color : white
Thermistor 3	567480C	Eva. out	Housing color : red

VJ

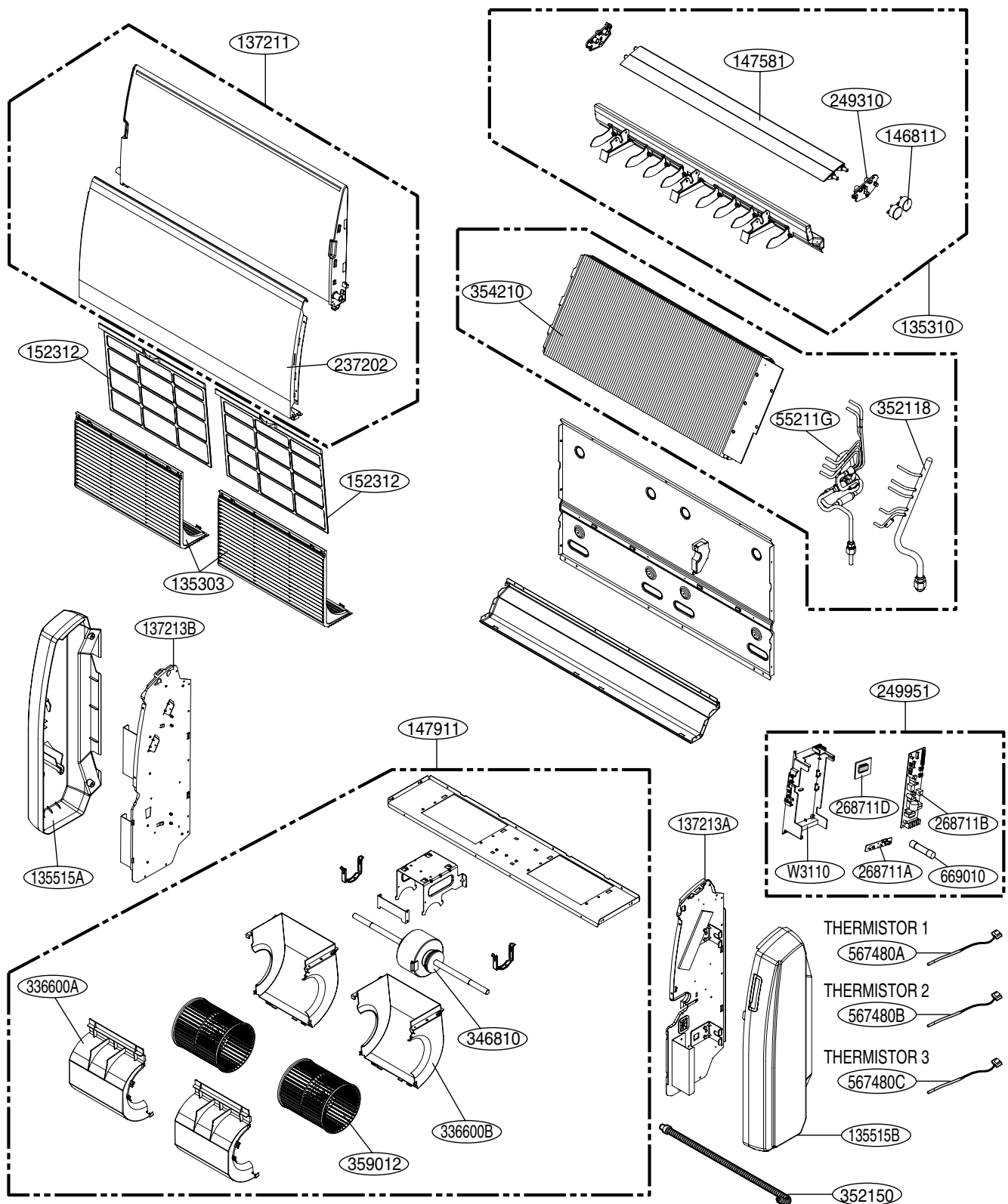

Thermistor 1	567480A	Air	Housing color : yellow
Thermistor 2	567480B	Eva. in	Housing color : white
Thermistor 3	567480C	Eva. out	Housing color : red



P/NO : MFL42947620

MAY, 2008